

The NEW standard in DRO systems. European design, low cost.

STERLING

20 years experience with international brands of DRO

LOW COST

In today's competitive market, we all need solutions that minimize our investment but that work reliably. Combine global product experience with low cost manufacturing & the result is a winning combination that's hard to beat.

SERVICE

Low cost no longer means no support or service. Due to the exceptional value for money, counters or linear scales can be replaced for less than the cost of "service" by international brands. *Plus, you get a full 12 month warranty!* Simply change a DRO or scale and save yourself \$\$\$ in the process! Or, call on one of our international dealers to assist you.

Sterling glass scales are compatible with other brands of DRO, and likewise, the DRO unit is compatible with other scales. Use our low cost to replace your old broken counters and scales today!



- Advanced multi-functional readout suitable for milling, turning, grinding, boring and other precision measuring applications.
- Status window providing operator assistance.
- Strong industrial cast iron casing.
- Auto compensating power supply 80v – 260v.

Designed with the machine operator's needs in mind, Sterling readout models provide clear function access with a carefully designed icon menu keypad. They represent exceptional value for money, providing the fastest possible return on investment. State-of-the-art surface mount chip technology is used in a single main PC board providing reliability and low manufacturing cost. Combined with linear glass scales, resolutions of 5µ or 1µ are available in lengths of 200 to 3,000mm. For long travel applications, Sterling offers a non contact magnetic system capable of reaching 100m measuring length. Sold globally through a network of system installers, you can rely on support no matter where you are.

Combining all the **standard** features you expect:

- MM / INCH Conversion
- Absolute / Incremental modes
- Auto position recall on power-on
- Centering function (1/2)
- 1 key axis zero

With advanced functions:

- Arc milling functions – multiple planes
- Bolt circle drilling (PCD)
- Oblique line drilling
- 200 Datum position memory
- Tool diameter compensation
- Rectangular pocket milling
- Taper measurement (lathe)

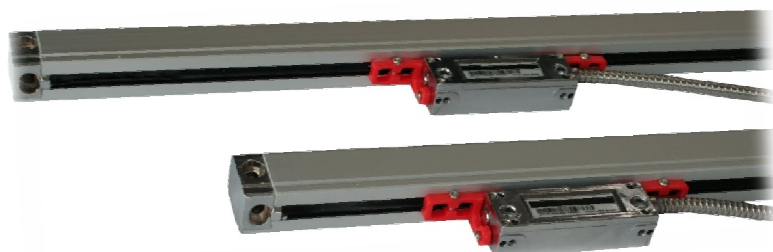

Specifications

ELECTRICAL

Voltage: 80 – 260Vac

Frequency: 50/60Hz

Power: 25VA max.

ENVIRONMENTAL

Operating temp: 0 ~ 45 °C.

Storage temp: -30 ~ 70 °C

Relative humidity: >90% (21 °C)

GENERAL

Weight: 3.2Kg

2 axis – SDS6-2V

3 axis – SDS6-3V

Display: 7 digit with +/- symbol

Frequency multiplication: 4x

Signal Input: 5V TTL

Max Input frequency: 5MHz

Resolutions: 5 μ, 1μ

Keypad: Sealed diaphragm



Icon style keys for easy function recognition.



Basic Functions:

- MM / Inch conversion
- Absolute / Incremental
- Auto position recall on power-on
- Centering function (1/2)
- One key axis zero
- Axis preset
- Built in calculator
- Radius / Diameter mode (Lathe)

Advanced Functions:

- Radius / Arc milling in multiple planes
- Bolt circle calc (PCD)
- Oblique line drilling
- 200 Datum position memory
- Tool diameter compensation
- Rectangular pocket milling
- Taper measurement (Lathe)
- Linear or segmented error compensations

Linear Scales

Sealed linear glass encoders for optimal accuracy. Hi precision aluminum body offering high rigidity, flatness, and ease of mounting.

- Available in 5μ & 1μ resolutions.
- Accuracy: $\pm 10\mu$, $\pm 5\mu$.
- Range: 70 ~ 3,000mm in glass
3050mm ~ 100m magnetic tape.
- Max Speed: 60 to 120m/min.
- Cable Length: 3m.
- Signal: 5v TTL Square wave.
- Working temp: 0 ~ 45 °C.

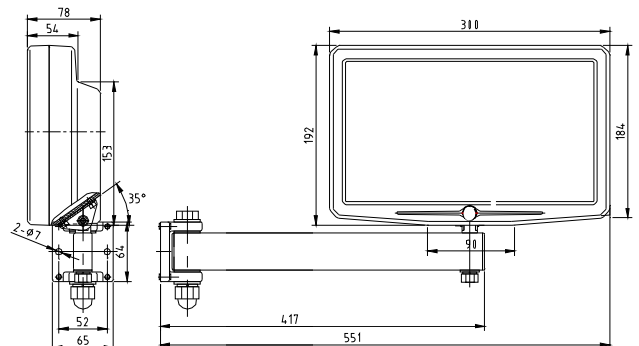

Authorized Distributor:

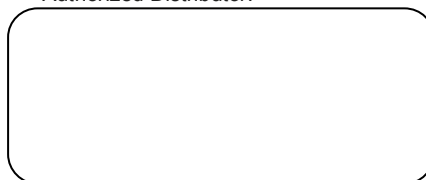

For more information on our products please visit:

www.dro.com.tw



STERLING

8F-2 No. 97 Taichung Kang Road Sec. 3
Taichung City, 40755, Taiwan.
T: 886 4 2358 8535 | F: 886 4 2358 8530
Email: info@dro.com.tw | www.dro.com.tw